



## Crown Road

Borehamwood, WD6 5JJ

**£325,000 Leasehold**

A rarely available two bedroom GROUND FLOOR GARDEN maisonette. Situated a quiet residential avenue the property comprises of a spacious lounge, large kitchen, two double bedrooms and modern bathroom. The property offers ample storage as well as being gas centrally heated and double glazed. The front and rear gardens are tidy and well kept. Other nearby properties have converted front gardens to driveways so this would be a possibility (subject to all relevant consents). The home is offered to the market chain free so early viewings are recommended to avoid any disappointment.

- Two Bedroom Maisonette
- Ground Floor
- Own Front & Rear Garden
- Large Rooms
- Modern Bathroom
- Chain Free

### Viewing

Please contact our Carrington Estate Agents Office on 02089531818 if you wish to arrange a viewing appointment for this property or require further information.



# Floor Plan

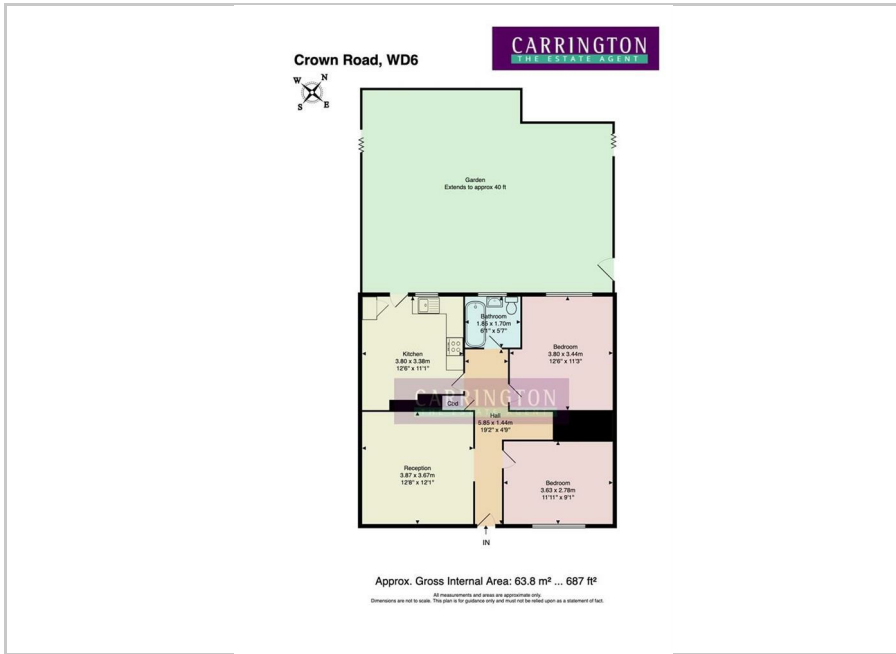

# Area Map



# Energy Efficiency Graph



These particulars, whilst believed to be accurate are set out as a general outline only for guidance and do not constitute any part of an offer or contract. Intending purchasers should not rely on them as statements of representation of fact, but must satisfy themselves by inspection or otherwise as to their accuracy. No person in this firm's employment has the authority to make or give any representation or warranty in respect of the property.

138 Shenley Road, Borehamwood, Hertfordshire WD6 1EF  
Tel: 020 8953 1818 Fax: 020 8953 0808

Email: [info@carrington-borehamwood.co.uk](mailto:info@carrington-borehamwood.co.uk) Website: [www.carrington-borehamwood.co.uk](http://www.carrington-borehamwood.co.uk)



COMPANY DIRECTOR: E. A. HUSSAIN  
REGISTERED ADDRESS: 1 WARNER HOUSE, HARROVIAN BUSINESS VILLAGE,  
BESSBOROUGH ROAD, HARROW, MIDD., HA1 3EX.  
COMPANY REGISTRATION No: 09830132